

**NORTHERN
PRESERVE
AREA 1
(322.8 AC.)**

**NORTHERN
PRESERVE
AREA 2
(565.6 AC.)**

**WESTERN
PRESERVE
(189.8 AC.)**

**INTERNAL
PRESERVE 1
(9.7 AC.)**

**WADING BIRD
FORAGING
AREAS
(8.7 AC.)**

**INTERNAL
PRESERVE 2
(13.8 AC.)**

**INTERNAL
PRESERVE 4
(10.6 AC.)**

**INTERNAL
PRESERVE 3
(2.8 AC.)**

**INTERNAL
PRESERVE 5
(0.80 AC.)**

**SUBJECT
PROPERTY**

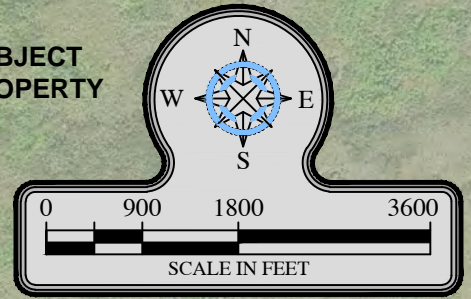

Turrell & Associates, Inc.
Marine & Environmental Consulting
3584 Exchange Ave. Suite B. Naples, FL 34104-3732
Email: tuna@turrell-associates.com Phone: (239) 643-0166 Fax: (239) 643-6632

**FLOW WAY CDD
OVERALL PRESERVE MAP**

| | | | | |
|------------------------------------|----------|-----------|-----------|----------|
| DESIGNED: | TH | REVISION: | TAB NAME: | OVERALL |
| DRAWN BY: | RMJ | N/A | SHEET: | |
| CREATED: | 06-21-17 | N/A | SCALE: | AS SHOWN |
| JOB NO.: | 9418 | N/A | | |
| SECTION- TOWNSHIP-48 S RANGE- 26 E | | | | |