

**STORMWATER MANAGEMENT SYSTEM LEGEND**

- STORMWATER POND (CDD OWNED TRACT)
- WETLAND (CDD OWNED TRACT)
- DRAINAGE MAINTENANCE AREA (CDD GRANTED ACCESS)

Wetland Name	Area (SF)	Area (AC)
Wetland 1	52052.7	1.2
Wetland 2	210337.6	4.8
Wetland 3	216324.9	5.0
Wetland 4	174185.3	4.0
Wetland 5	257043.7	5.9
Wetland 6	167374.5	3.8
Wetland 10	345315.3	7.9
Wetland 13	127391.9	2.9
Wetland 16A	172841.3	4.0
Wetland 16B	453963.6	10.4
Wetland 16C	102451.6	2.4
Wetland 21	23582.9	0.5
Wetland 41	271730.9	6.2
Wetland 46A	171080.6	3.9
Wetland 46B	92305.4	2.1
Wetland 47	153891.2	3.5
Wetland 48A	93719.4	2.2
<b>Total</b>	<b>3085592.7</b>	<b>70.8</b>

Lake Name	Area (SF)	Area (AC)
Sump PW-1	7531.8	0.2
Lake 1W	97685.6	2.2
Lake 1E	121080.4	2.8
Sump PW-2	5034.7	0.1
Lake L-2	88211.0	2.0
Lake 16	29259.8	0.7
Lake L-4	66647.3	1.5
Lake L-6	19276.2	0.4
Lake 7	60908.9	1.4
Lake L-3	200949.3	4.6
Lake L-3N	88020.5	2.0
Lake L-9	104122.0	2.4
Lake 8	68424.3	1.6
Lake 15B	69500.2	1.6
Lake 15C	51317.8	1.2
Sump PW-10A	11325.3	0.3
Sump A	10882.5	0.2
Sump W-10	12057.1	0.3
Lake L18E	236214.8	5.4
Sump PW-13	11055.7	0.3
Sump PW-46A1	22330.0	0.5
Sump PW-46A2	37140.7	0.9
Lake 22B	60036.5	1.4
Sump PW-16B1	7751.2	0.2
Lake 20	77080.6	1.8
Lake 22	15798.1	0.4
Lake 24A	63178.0	1.5
Lake 24	78785.6	1.8
Lake 23	102141.9	2.3
Sump PW-48A1	18630.6	0.4
Lake L-18D	126262.2	2.9
Lake L-18W	67930.2	1.6
Lake L-18C	328363.2	7.5
Lake L18-N	212214.3	4.9
Lake 44	48286.3	1.1
Lake 13	118114.1	2.7
Lake 11	332706.6	7.6
Lake 10	374817.5	8.6
<b>Total</b>	<b>3451072.8</b>	<b>79.2</b>

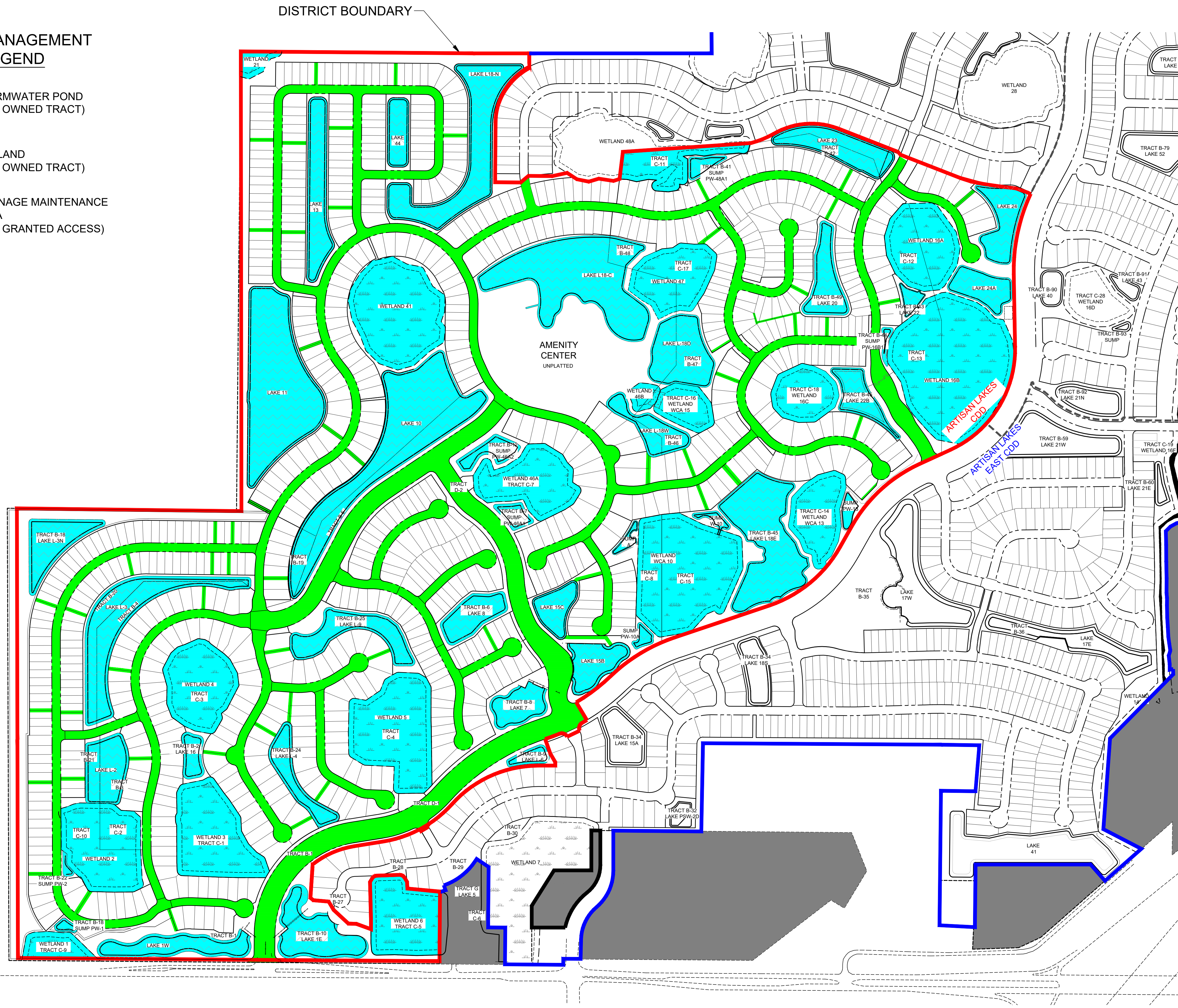

**NOTE:**

THE OPERATION AND MAINTENANCE ENTITY SHALL PROVIDE FOR THE INSPECTION OF THE PERMITTED PROJECT AFTER CONVERSION OF THE PERMIT TO THE OPERATION AND MAINTENANCE PHASE. FOR SYSTEMS UTILIZING RETENTION OR WET DETENTION, THE INSPECTIONS SHALL BE PERFORMED FIVE (5) YEARS AFTER OPERATION IS AUTHORIZED AND EVERY FIVE (5) YEARS THEREAFTER.

THE OPERATION AND MAINTENANCE ENTITY MUST MAINTAIN A RECORD OF EACH INSPECTION, INCLUDING THE DATE OF INSPECTION, THE NAME AND CONTACT INFORMATION OF THE INSPECTOR, WHETHER THE SYSTEM WAS FUNCTIONING AS DESIGNED AND PERMITTED, AND MAKE SUCH RECORD AVAILABLE UPON REQUEST OF THE DISTRICT.

WITHIN 30 DAYS OF ANY FAILURE OF A STORMWATER MANAGEMENT SYSTEM OR DEVIATION FROM THE PERMIT, AN INSPECTION REPORT SHALL BE SUBMITTED USING FORM 62-330.311(1), "OPERATION AND MAINTENANCE INSPECTION CERTIFICATION" DESCRIBING THE REMEDIAL ACTIONS TAKEN TO RESOLVE THE FAILURE OR DEVIATION.

I:\Projects\2022\21\Artisan\_Lakes\_CDD\Drawings\Enhancements\22-21-E-10-Maint-Enhancements\Plan\REV01\VAL\_CDD\_O&M\_Enhmt.dwg  
 1/19/2024 2:07:31 PM

