

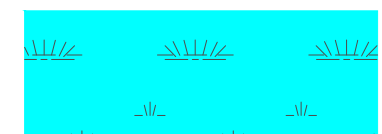

STORMWATER MANAGEMENT SYSTEM LEGEND

-  STORMWATER POND (CDD OWNED TRACT)
-  WETLAND (CDD OWNED TRACT)
-  DRAINAGE MAINTENANCE AREA (CDD GRANTED ACCESS)

NOTE: PLEASE REFER TO APPROVED CONSTRUCTION PLANS FOR DRAINAGE PIPE LOCATIONS AND OUTFALLS

| Wetland Name | Area (SF) | Area (AC) |
|--------------|-----------|-----------|
| Wetland 7 | 293613.5 | 6.7 |
| Wetland 14 | 36612.09 | 0.8 |
| Wetland 16F | 138778.4 | 3.2 |
| Wetland 16D | 98439.1 | 2.3 |
| Wetland 16E | 109127.8 | 2.5 |
| Wetland 22 | 24191.3 | 0.6 |
| Wetland 23 | 35157.0 | 0.8 |
| Wetland 24 | 49716.7 | 1.1 |
| Wetland 25 | 183813.4 | 4.2 |
| Wetland 28 | 236002.2 | 5.4 |
| Wetland 31 | 71230.0 | 1.6 |
| Wetland 32 | 316496.7 | 7.3 |
| Wetland 37 | 141439.2 | 3.2 |
| Wetland 40 | 127125.8 | 2.9 |
| Wetland 48A | 198729.6 | 4.6 |
| Wetland 48B | 155203.5 | 3.6 |
| Wetland 52 | 30629.9 | 0.7 |
| Total | 2246305.8 | 51.6 |

| Lake Name | Area (SF) | Area (AC) |
|-------------|-----------|-----------|
| Lake 15A | 63452.7 | 1.5 |
| Lake PSW-2D | 16536.2 | 0.4 |
| Lake 18S | 52349.5 | 1.2 |
| Lake 41 | 172860.6 | 4.0 |
| Lake 17E | 94617.6 | 2.2 |
| Lake 17W | 162045.3 | 3.7 |
| Lake 21E | 14238.1 | 0.3 |
| Lake 21W | 116919.0 | 2.7 |
| Lake 21N | 50532.5 | 1.2 |
| Lake 40 | 25492.0 | 0.6 |
| B-93 Sump | 4198.0 | 0.1 |
| Lake 43 | 13917.4 | 0.3 |
| Lake 50 | 15963.4 | 0.4 |
| Lake 51 | 80952.7 | 1.9 |
| Lake 45 | 103478.2 | 2.4 |
| Lake 46 | 92544.2 | 2.1 |
| Lake 49 | 60061.8 | 1.4 |
| Lake 52 | 70728.7 | 1.6 |
| Lake 48 | 20051.5 | 0.5 |
| Lake 53 | 38732.9 | 0.9 |
| Lake 47 | 91653.3 | 2.1 |
| Lake 37 | 119518.6 | 2.7 |
| Pond 56 | 38019.4 | 0.9 |
| Lake 34 | 24965.2 | 0.6 |
| Lake 35 | 29331.0 | 0.7 |
| Pond 25 | 36166.9 | 0.8 |
| Pond 23A | 102290.2 | 2.3 |
| Pond 23B | 181017.9 | 4.2 |
| Pond 37A | 43749.5 | 1.0 |
| Pond 37B | 6701.5 | 0.2 |
| Pond 23C | 18864.6 | 0.4 |
| Pond 48A4 | 13928.3 | 0.3 |
| Pond 48A3 | 8198.9 | 0.2 |
| Pond 48A2 | 11619.4 | 0.3 |
| Total | 1995696.8 | 45.8 |

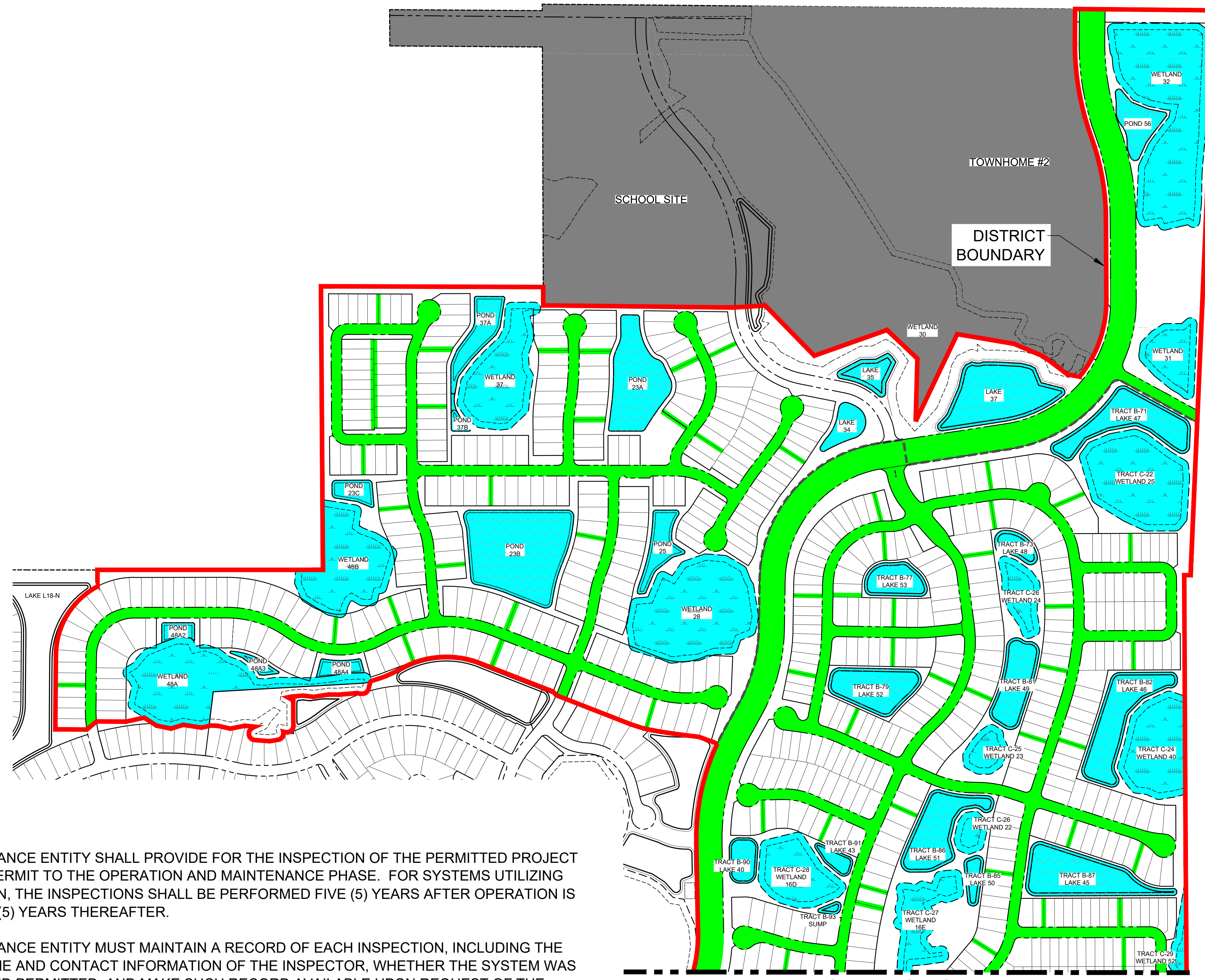

NOTE:

THE OPERATION AND MAINTENANCE ENTITY SHALL PROVIDE FOR THE INSPECTION OF THE PERMITTED PROJECT AFTER CONVERSION OF THE PERMIT TO THE OPERATION AND MAINTENANCE PHASE. FOR SYSTEMS UTILIZING RETENTION OR WET DETENTION, THE INSPECTIONS SHALL BE PERFORMED FIVE (5) YEARS AFTER OPERATION IS AUTHORIZED AND EVERY FIVE (5) YEARS THEREAFTER.

THE OPERATION AND MAINTENANCE ENTITY MUST MAINTAIN A RECORD OF EACH INSPECTION, INCLUDING THE DATE OF INSPECTION, THE NAME AND CONTACT INFORMATION OF THE INSPECTOR, WHETHER THE SYSTEM WAS FUNCTIONING AS DESIGNED AND PERMITTED, AND MAKE SUCH RECORD AVAILABLE UPON REQUEST OF THE DISTRICT.



WITHIN 30 DAYS OF ANY FAILURE OF A STORMWATER MANAGEMENT SYSTEM OR DEVIATION FROM THE PERMIT, AN INSPECTION REPORT SHALL BE SUBMITTED USING FORM 62-330.311(1), "OPERATION AND MAINTENANCE INSPECTION CERTIFICATION" DESCRIBING THE REMEDIAL ACTIONS TAKEN TO RESOLVE THE FAILURE OR DEVIATION.



I:\Users\JL\My Documents\Projects\2023\31\Artisan Lakes East CDD\Drawings\Exhibits\23-31-022 Main Exhibit\Current Plans\REV01\ALE_CDD_O&M_Enbbl.dwg
 1/19/2024 2:02:52 PM

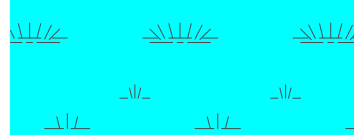

STORMWATER MANAGEMENT SYSTEM LEGEND

-  STORMWATER POND (CDD OWNED TRACT)
-  WETLAND (CDD OWNED TRACT)
-  DRAINAGE MAINTENANCE AREA (CDD GRANTED ACCESS)

NOTE: PLEASE REFER TO APPROVED CONSTRUCTION PLANS FOR DRAINAGE PIPE LOCATIONS AND OUTFALLS

| Lake Name | Area (SF) | Area (AC) |
|-------------|-----------|-----------|
| Lake 15A | 63452.7 | 1.5 |
| Lake PSW-2D | 16536.2 | 0.4 |
| Lake 18S | 52349.5 | 1.2 |
| Lake 41 | 172860.6 | 4.0 |
| Lake 17E | 94617.6 | 2.2 |
| Lake 17W | 162045.3 | 3.7 |
| Lake 21E | 14238.1 | 0.3 |
| Lake 21W | 116919.0 | 2.7 |
| Lake 21N | 50532.5 | 1.2 |
| Lake 40 | 25492.0 | 0.6 |
| B-93 Sump | 4198.0 | 0.1 |
| Lake 43 | 13917.4 | 0.3 |
| Lake 50 | 15963.4 | 0.4 |
| Lake 51 | 80952.7 | 1.9 |
| Lake 45 | 103478.2 | 2.4 |
| Lake 46 | 92544.2 | 2.1 |
| Lake 49 | 60061.8 | 1.4 |
| Lake 52 | 70728.7 | 1.6 |
| Lake 48 | 20051.5 | 0.5 |
| Lake 53 | 38732.9 | 0.9 |
| Lake 47 | 91653.3 | 2.1 |
| Lake 37 | 119518.6 | 2.7 |
| Pond 56 | 38019.4 | 0.9 |
| Lake 34 | 24965.2 | 0.6 |
| Lake 35 | 29331.0 | 0.7 |
| Pond 25 | 36166.9 | 0.8 |
| Pond 23A | 102290.2 | 2.3 |
| Pond 23B | 181017.9 | 4.2 |
| Pond 37A | 43749.5 | 1.0 |
| Pond 37B | 6701.5 | 0.2 |
| Pond 23C | 18864.6 | 0.4 |
| Pond 48A4 | 13928.3 | 0.3 |
| Pond 48A3 | 8198.9 | 0.2 |
| Pond 48A2 | 11619.4 | 0.3 |
| Total | 1995696.8 | 45.8 |

| Wetland Name | Area (SF) | Area (AC) |
|--------------|-----------|-----------|
| Wetland 7 | 293613.5 | 6.7 |
| Wetland 14 | 36612.09 | 0.8 |
| Wetland 16F | 138778.4 | 3.2 |
| Wetland 16D | 98439.1 | 2.3 |
| Wetland 16E | 109127.8 | 2.5 |
| Wetland 22 | 24191.3 | 0.6 |
| Wetland 23 | 35157.0 | 0.8 |
| Wetland 24 | 49716.7 | 1.1 |
| Wetland 25 | 183813.4 | 4.2 |
| Wetland 28 | 236002.2 | 5.4 |
| Wetland 31 | 71230.0 | 1.6 |
| Wetland 32 | 316496.7 | 7.3 |
| Wetland 37 | 141439.2 | 3.2 |
| Wetland 40 | 127125.8 | 2.9 |
| Wetland 48A | 198729.6 | 4.6 |
| Wetland 48B | 155203.5 | 3.6 |
| Wetland 52 | 30629.9 | 0.7 |
| Total | 2246305.8 | 51.6 |

NOTE:

THE OPERATION AND MAINTENANCE ENTITY SHALL PROVIDE FOR THE INSPECTION OF THE PERMITTED PROJECT AFTER CONVERSION OF THE PERMIT TO THE OPERATION AND MAINTENANCE PHASE. FOR SYSTEMS UTILIZING RETENTION OR WET DETENTION, THE INSPECTIONS SHALL BE PERFORMED FIVE (5) YEARS AFTER OPERATION IS AUTHORIZED AND EVERY FIVE (5) YEARS THEREAFTER.

THE OPERATION AND MAINTENANCE ENTITY MUST MAINTAIN A RECORD OF EACH INSPECTION, INCLUDING THE DATE OF INSPECTION, THE NAME AND CONTACT INFORMATION OF THE INSPECTOR, WHETHER THE SYSTEM WAS FUNCTIONING AS DESIGNED AND PERMITTED, AND MAKE SUCH RECORD AVAILABLE UPON REQUEST OF THE DISTRICT.

WITHIN 30 DAYS OF ANY FAILURE OF A STORMWATER MANAGEMENT SYSTEM OR DEVIATION FROM THE PERMIT, AN INSPECTION REPORT SHALL BE SUBMITTED USING FORM 62-330.311(1), "OPERATION AND MAINTENANCE INSPECTION CERTIFICATION" DESCRIBING THE REMEDIAL ACTIONS TAKEN TO RESOLVE THE FAILURE OR DEVIATION.

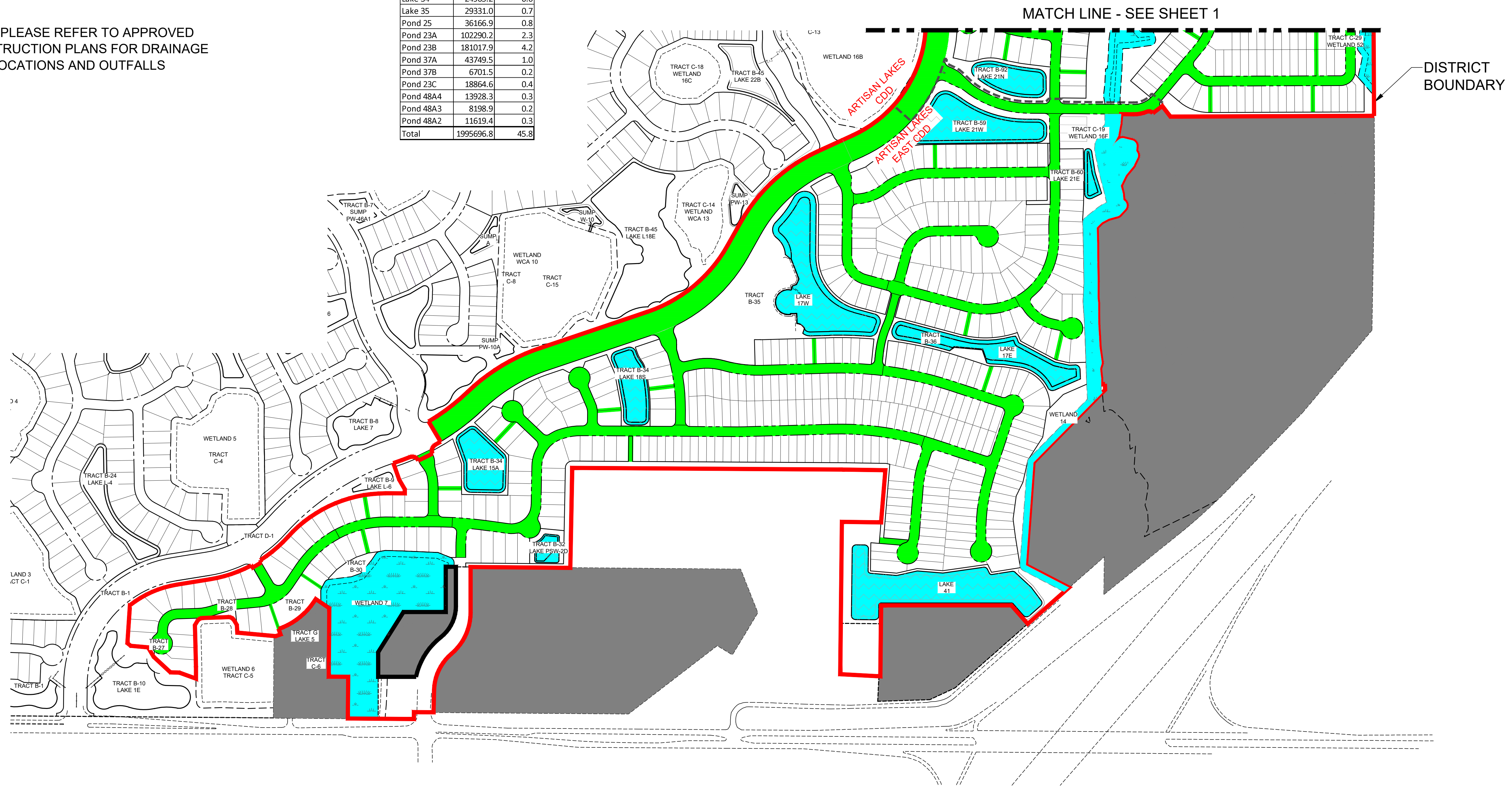

I:\Projects\2023\23-35_Artisan_Lakes_CDD_Enhancement\Current\Plan\REV01\ALE_CDD_O&M_Enhance.dwg 1/19/2024 1:57:37 PM